

Flow Indicator M1J



- No electrical supply required
- Individually calibrated display range
- Compact design

Characteristics

A piston fitted with a magnet is pushed through the medium against the force of a spring. This activates the pointer of the measuring device by means of a magnetic coupling. Because of the hermetic separation from the medium, the display unit cannot be soiled by the medium.

Technical data

Switch	without	
Nominal width	DN 8..25	
Process connection	female thread G 1/4..G 1 (further process connections available on request)	
Display range	0.4..60 l/min	for details see table "Ranges"
Pressure loss	0.4..1.4 bar at Q _{max.}	
Q_{max.}	to 80 l/min	
Tolerance	±5 % of full scale value	
Pressure resistance	PN 200 bar	
Media temperature	-20..+120 °C	
Ambient temperature	-20..+70 °C	
Media	water (oils, gases and aggressive media available on request)	
Electrical data	none	
Materials medium-contact	<i>Brass construction:</i> CW614N nickelled, CW614N, 1.4310, hard ferrite, NBR	<i>Stainless steel construction:</i> 1.4571, 1.4404, 1.4310, hard ferrite PTFE-coated, FKM
Non-medium-contact materials	Acrylic, NBR	
Weight	see table "Dimensions and weights"	
Installation location	Standard: horizontal inwards flow from the left; other installation positions are possible; the installation position affects the display range.	

Ranges

Details in the table correspond to horizontal inwards flow with increasing flow rate.

Scaling is via a 10..100 % display.

Display range l/min H ₂ O	Q _{max.} recommended	Pressure loss bar at Q _{max.} H ₂ O
0.4 - 4	10	0.6
1.0 - 10	20	
2.0 - 20	30	0.4
3.0 - 30	40	
4.0 - 40	60	0.8
6.0 - 60	80	1.4

Special ranges are available.

Dimensions and weights

	G	Types	SW	X	Weight kg
Brass	G 1/4	M1J-008GM	40	15	1.2
	G 3/8	M1J-010GM			
	G 1/2	M1J-015GM			
	G 3/4	M1J-020GM		18	1.1
	G 1	M1J-025GM		1.0	
Stainless steel	G 1/4	M1J-008GK	41	15	1.2
	G 3/8	M1J-010GK			
	G 1/2	M1J-015GK			
	G 3/4	M1J-020GK		18	1.1
	G 1	M1J-025GK		1.0	

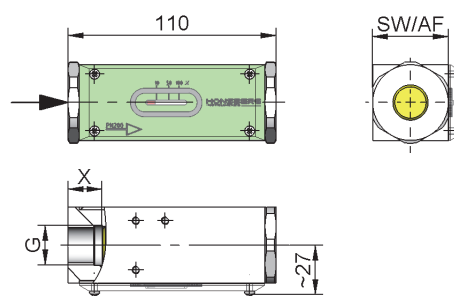

Product Information

M1J-008..025GM / K

Handling and operation

- Include straight calming section of 5 x DN in inlet and outlet
- If the media are dirty, install a filter
(use magnetic filter for ferritic components)

Options

- Special ranges/special scaling
- Temperature display 0..120 °C
- Reinforced piston

Ordering code

M1
M1 -

Ordering information

- Specify direction of flow, medium, and display range.
- For oils. State viscosity, temperature and designation (e.g. ISO VG 68) (enquire about display range).
- For gases, state pressure (relative or absolute), temperature and medium (e.g. air) (request display range)

1. Display		
J		with frontal measurement display J
2. Nominal width		
008		DN 8 - G 1/4
010		DN 10 - G 3/8
015		DN 15 - G 1/2
020		DN 20 - G 3/4
025		DN 25 - G 1
3. Process connection		
G		female thread
4. Connection material		
M		brass
K		stainless steel
5. Display range H₂O for horizontal inwards flow		
004		0.4 - 4 l/min
010		1.0 - 10 l/min
020		2.0 - 20 l/min
030		3.0 - 30 l/min
040		4.0 - 40 l/min
060		6.0 - 60 l/min